

Remove contents of box.

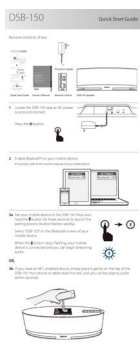

Quick Start Guide



Owner's Manual

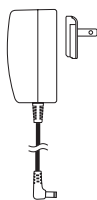

AC power supply

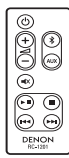

Remote Control

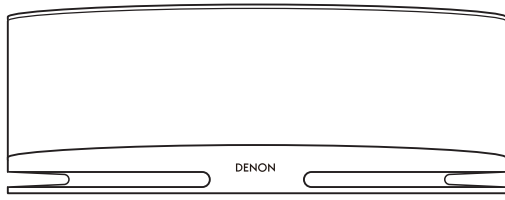

DSB-150 speaker

1 Locate the DSB-150 near an AC power source and connect.

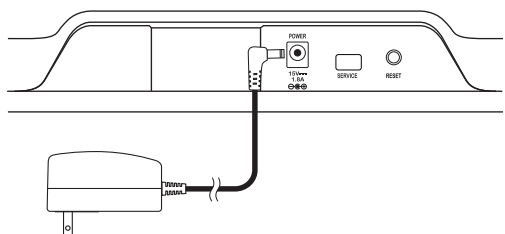

Press the  button.



2 Enable *Bluetooth*® on your mobile device.

If necessary, refer to the owner's manual of your mobile device.

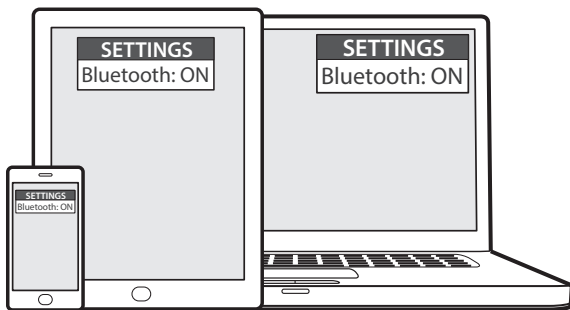

3a Pair your mobile device to the DSB-150. Press and hold the  button for three seconds to launch the pairing process (button flashes rapidly).

Select "DSB-150" on the *Bluetooth* screen of your mobile device.

When the  button stops flashing, your mobile device is connected and you can begin streaming audio.

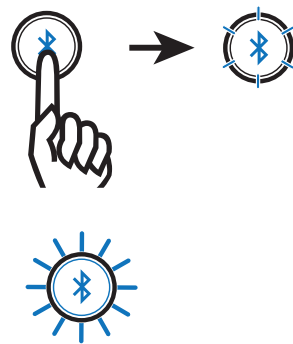

OR,

3b If you have an NFC enabled device, simply place it gently on the top of the DSB-150. Your phone or tablet does the rest, and you can be playing audio within seconds.

